

State of S<sup>c</sup> Carolina Pursuant to a warrant from John Thomas Esq<sup>r</sup> Commissioner of Locations in 96 Dist<sup>ct</sup> No. Saluda River dated the 23<sup>rd</sup> July 1784 I have admeasured & laid out three Acre and a half a Tract of Land containing one hundred Acres Below the Indian Boundary on a Small Branch of Grove River Bounded on all Sides on Various Land & in the said Tract are certain Marks as the Annex<sup>d</sup> plat Represents Survey<sup>d</sup> the 26<sup>th</sup> July 1784

Recorded the 22<sup>nd</sup> Dec<sup>r</sup> 1784  
Delivered to Adam Birchfield

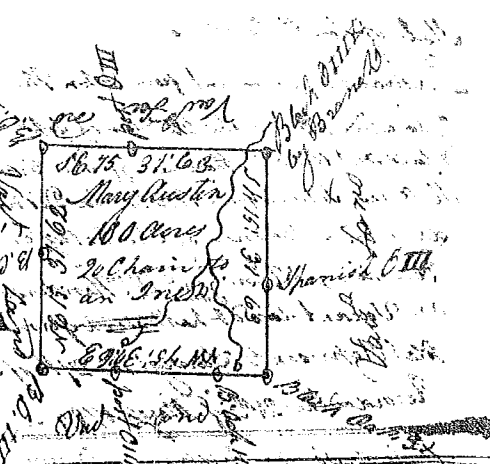

S<sup>c</sup> Carolina Pursuant to a warrant from John Thomas Esq<sup>r</sup> Commissioner of Locations for 96 Dist<sup>ct</sup> No. Saluda River I have Surveyed & laid out unto Wm Stark a Tract of One hundred & seventy six acres of land in the said District situate on Pattersons creek a Branch of Indian Creek Bounding N<sup>w</sup> Jacob Kingsland Esq<sup>r</sup> on W<sup>m</sup> Mclentock N<sup>w</sup> on land not known & West on land of Rev<sup>d</sup> Robert Mclentock. Having set forth & marks as the Annex<sup>d</sup> plat Represents Survey<sup>d</sup> the 4<sup>th</sup> Oct<sup>r</sup> 1784

Recorded the 22<sup>nd</sup> Dec<sup>r</sup> 1784  
John Parsons

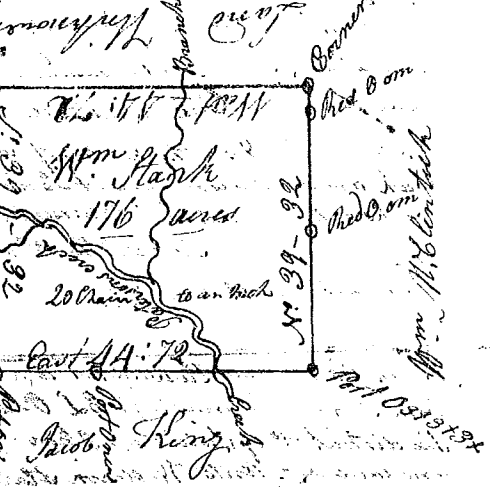

State of S<sup>c</sup> Carolina Pursuant to a warrant from John Thomas Esq<sup>r</sup> Commissioner of Locations I have admeasured & laid out unto John Huston Jun<sup>r</sup> a Tract of fifty eight acres of Land situate in Ninety six District below the line or Waters of Golden creek Bounding N<sup>w</sup> on land laid out to Mrs<sup>e</sup> Connors N<sup>w</sup> on Mrs<sup>e</sup> Hillin & N<sup>e</sup> on Patrick Lewis John Mclentock & John Huston and hath set forth the same & marks as the Annex<sup>d</sup> plat Represents. Survey<sup>d</sup> the 20<sup>th</sup> Oct<sup>r</sup> 1784

Recorded the 22<sup>nd</sup> Dec<sup>r</sup> 1784  
Benjamin Glavin

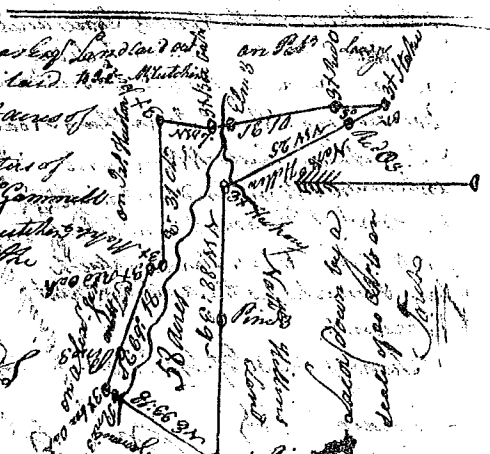

State of South Carolina Below the line Pursuant to a warrant from John Thomas Esq<sup>r</sup> Com<sup>r</sup> Loc<sup>r</sup> I have admeasured and laid out unto John Huston Jun<sup>r</sup> a Tract of one hundred & seven and a half acres of Land situate in Ninety six District on Indian creek Bounding W<sup>m</sup> on land laid out to J<sup>r</sup> Batts & W<sup>m</sup> Cannon S<sup>e</sup> on Thomas Dugan & J<sup>r</sup> Keeble N<sup>e</sup> on John Huston Jun<sup>r</sup> and hath set forth the same & marks as the Annex<sup>d</sup> plat Represents Survey<sup>d</sup> the 14<sup>th</sup> Oct<sup>r</sup> 1784

Recorded the 22<sup>nd</sup> Dec<sup>r</sup> 1784

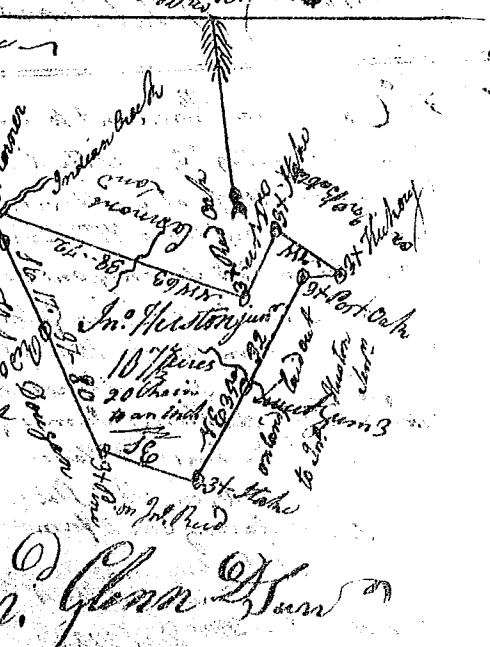

Benjamin Glavin